

E45 Opening Window & Door System

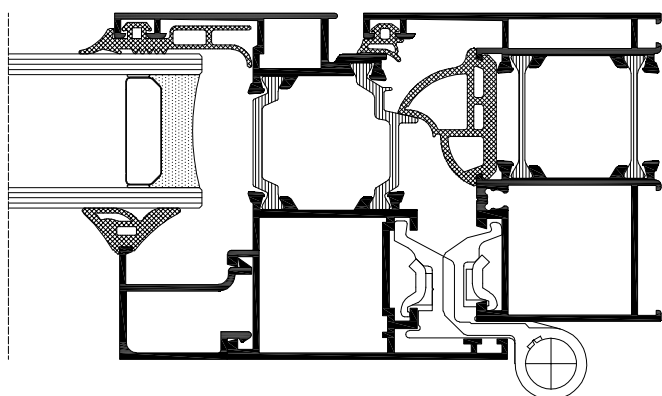

Optimised for advanced mechanical performance.
Wide variety of profiles and typologies is available.
Profiles can be reinforced at the load bearing areas when necessary.



Performances	Window	Door
Air permeability:	up to Class 4	up to Class 4
Watertightness:	up to Class E1950	up to Class 5A
Resistance to wind load:	up to Classes AE2500 / C5	up to Class C4
Thermal transmittance (U_p):	from 1.9 W/(m²K)	from 2.1 W/(m²K)
Acoustic performance:	up to 50 dB	
Burglar resistance:	up to Class WK2	up to Class WK2 (one leaf)

Typologies

- Turn, tilt & turn, tilt, projecting, folding, pivoting, fixed, parallel sliding
- Inwards & outwards opening
- Single & double leaf
- Rectangular, variable angle & bended

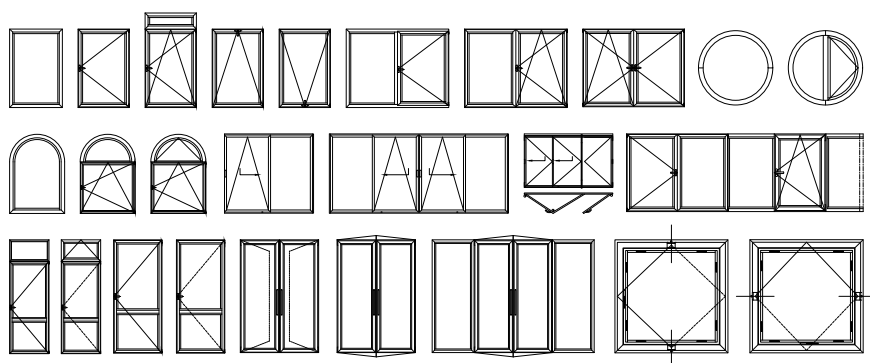

Technical features

- Fixed frame (min. depth): 60 mm
- Sash frame (min. depth): 67.5 mm
- Min.height of window/door: 82.5 mm/97.5 mm
- Straight & curved profiles
- Smoke control doors
- Hidden vent
- Single, double & triple glazing option
- Glazing infill: up to 40 mm in frame
- Max. vent width: 1600 x 1600 mm
- Max. vent height: 950 x 2300 mm
- Energy efficiency concepts: Advanced, Improved & Basic

Hardware

- Eurogroove & PVC groove
- Max. leaf weight: 140 kg
- Concealed, external and bridge hinges

Surface treatment options

- RAL colours
- ETEM colours
- Anodising
- Wood effects
- Quality Standards:
 - QUALICOAT
 - QUALANOD
 - QUALIDECO

Production certificates

- EN ISO 9001
- EN ISO 14001
- OHSAS 18001

